

MAB 150

Horizontal magnetic core drilling machine with angular gear, ideally suited for most confined drilling situations.





The advantages of the MAB 150

- > Only 11 kg – especially light-weight and handy
- > Feed handle changeable from the left to the right side of the machine
- > Core drills up to \varnothing 35 mm



SPECIFICATION

	Motor output:	1080 Watt
	Voltage:	230 V AC, 50-60 Hz
	Stroke:	39 mm
	Swivel Base, adjustment feature:	–
	Magnet size:	80 x 160 x 36.5 mm
	Weight:	11 kg
	Direct arbor:	19 mm Weldon ($\frac{3}{4}$ "
	Industrial arbor:	–
	Quick change drill chuck system:	–
	Morse taper:	–
	Speed range 1:	400 min ⁻¹
	Speed range 2:	–
	Speed range 3:	–
	Speed range 4:	–
	Permanent internal lubrication:	✓

	Friction clutch:	–
	Torque control:	–
	Full wave control electronics:	–
	Magnet indicator:	–
	Overheating protection:	–
	CW/CCW rotation:	–
	Carbon brush wear control:	–
	Core drill short 30 mm:	12 – 35 mm
	Core drill long 55 mm:	–
	Core drill extra-long 110 mm:	–
	Twist drilling:	–
	Reaming:	–
	Countersinking:	–
	Thread cutting:	–

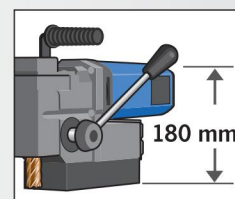

Low design height

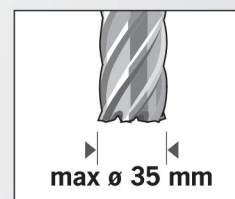

Core drilling up to \varnothing 35 mm

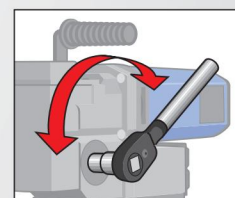

Optionally with ratchet

ORDER NO.

MAB 150 230 Volt
MAB 150 110/125 Volt
MAB 150 with lever drill 230 Volt
MAB 150 with lever drill 110/125 Volt

Technical drawing: Page 42-43

SCOPE OF DELIVERY

1 Magnetic core drilling machine
1 Ejector pin ZAK 075
1 Hard protective case
1 Safety chain
1 Cutting oil pump bottle ZKP 100
1 Offset screwdriver SW 4
1 Operating manual