

Technical Data

Rating at 60% duty cycle
(10 min. cycle)

- Mixed gas: 200 A
- CO₂: 230 A

Cooling method Gas cooling

Wire diameter 0.8 - 1.2 mm

Gas flow 12 l/min

Technical specification according to IEC 60974-7

Connection Euro-Central connector
Other connectors are available upon request.

Torch rating will be reduced when using pulsed-arc power sources.



Contact tips

	Pos.	Material	Part no.
M6	▶ 10	ECu, M6 x 28	340P__1069*
		CuCrZr, M6x28	340P__3069*
		Alu, ECu, M6x28	341P__1069*
M8	11	ECu, M8x30	340P__1262*
		CuCrZr, M8x30	340P__3262*
		Alu, ECu, M8x30	341P__1262*

▶ = Standard equipment

* At the blank, please insert suitable information for torch length or wire diameter, e.g. 3 for 3 m or 08 for 0.8 mm.

Tip holders

	Pos.	Material	Part no.
	▶ 20	for contact tip M6	342P006003
	21	for contact tip M8	342P008003

Ordering information for torches

Supplied equipped for steel wire Ø 1.0 mm.
Liner, red (Ø 1.0 - 1.2 mm).

Torch	Configuration	Length	Part no.
TBi 250 Expert	Adapter nut ,basic'	3 m	104P321030
		4 m	104P321040
		5 m	104P321050
TBi 250 Expert	Adapter nut ,brass'	3 m	104P721030
		4 m	104P721040
		5 m	104P721050
TBi 250 Expert	Long trigger (Adapter nut ,basic')	3 m	104P3L1030
		4 m	104P3L1040
		5 m	104P3L1050
TBi 250 Expert	Long trigger (Adapter nut ,brass')	3 m	104P7L1030
		4 m	104P7L1040
		5 m	104P7L1050

Spare parts

Pos.	Description	Part no.
50	Torch neck TBi 250, 50°	104P001008
51	Nozzle spring TBi 250/351	103P002006
52	PVC body	600P002017
60	Handle Expert cpl., gas cooled	380P230001
61	Handle Expert cpl., gas cooled, long trigger	380P230002
62	Screw for Expert handle	100P541101
63	Trigger, red, 2 poles	385P021016
64	Trigger, red, 2 poles, long	385P021018

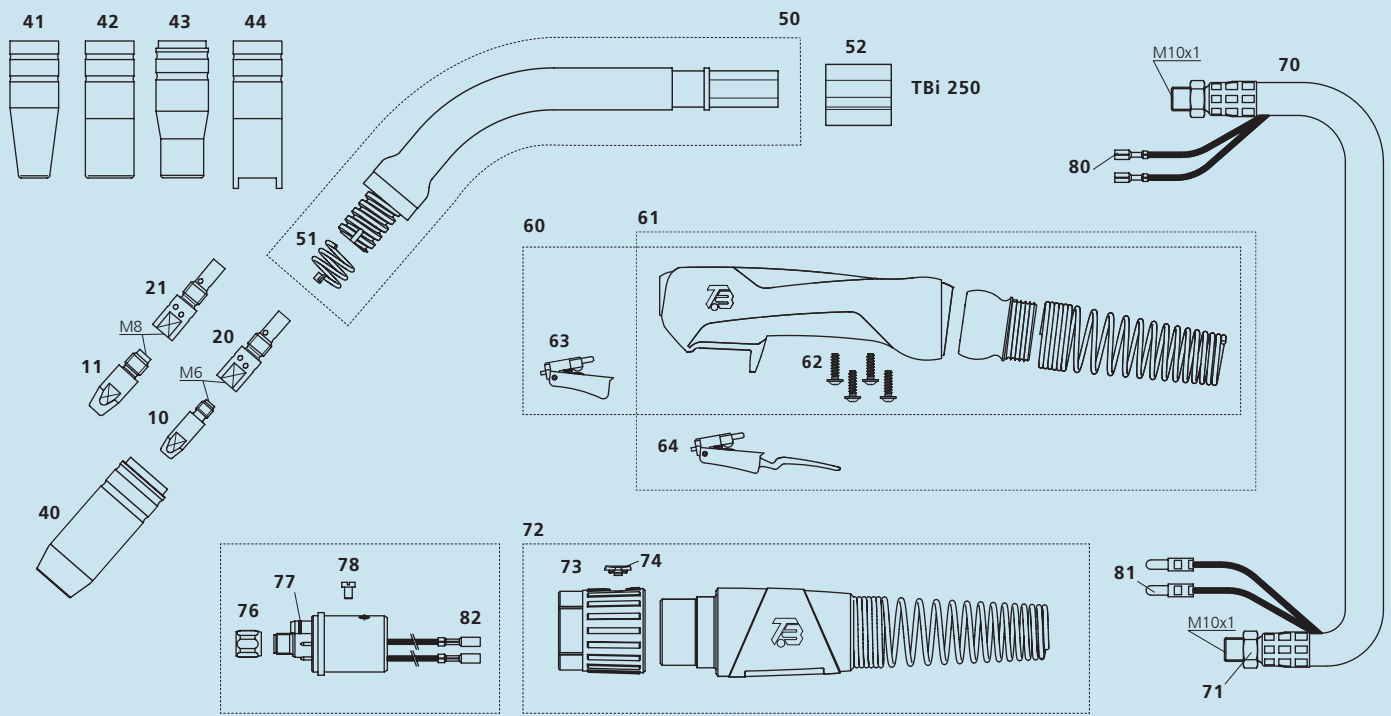

Gas nozzle

Pos.	Description	Part no.
40	conical, NW 15 mm L= 56.8 mm	345P012003
40	conical, NW 15 mm long insulation L= 56.8 mm	345P012303
41	conical, NW 11 mm only for M6 L= 56.2 mm	345P013003
42	cylindrical, NW 20 mm long insulation L= 56.2 mm	345P011303

Pos.	Description	Part no.
43	bottle form, NW 14 mm L= 56.2 mm	345P014003
43	bottle form, NW 11 mm only for M6 L= 56.2 mm	345P014303
44	spot welding nozzle NW 19mm, long insulation L= 66.7 mm	345P015503

Pos.	Description	Part no.
70	Coaxial cable TBi ProFlex M	361P0M11_0*
71	Hex nut M10x1	101P002005
72	Cable support Expert cpl., gas cooled, 'Basic'	700P001061
73	Adaptor nut Expert (basic version)	700P002161
—	Adaptor nut Expert (brass)	700P001010
74	Cap for adaptor nut Expert	700P002059
75	Central adaptor ESG cpl., 2 poles, moveable pins	701P001048
76	Sleeve nut M10x1	701P002005
77	O-ring 4.0x1.0 mm (gas nipple)	365P100040
78	Screw M4x6	100P008401

Pos.	Description	Part no.
80	Cable lug, flat	375P000023
81	Insulated connector, male, round	375P000004
82	Insulated connector, female, round	375P000003

Ready for Tomorrow.



Welding Company België
Brandekensweg 6 | 2627 Schelle
Tel.: +32 3 880 81 80
info@weldingcompany.be

Welding Company Nederland
Ambachtsweg 2 | 4128 LC Lexmond
Tel.: +31 3 347 745008
info@weldingcompany.nl