

**MIG/MAG Welding torches**  
*TBi Expert*



## Technical Data

Rating at 100% duty cycle  
(10 min. cycle)

- Mixed gas: 450 A  
- bei CO<sub>2</sub>: 500 A

Cooling method Water cooling

Wire diameter 1.0 - 1.6 mm

Gas flow 16 l/min

Technical specification according to IEC 60974-7

Connection Euro-Central connector  
Other connectors are available upon request.

Torch rating will be reduced when using pulsed-arc power sources.



## Contact tips

M8

| Pos.              | Part no.    |
|-------------------|-------------|
| ▶ 10 ECu, M8 x 30 | 340P__1262* |
| CuCrZr, M8x30     | 340P__3262* |
| Alu, ECu, M8x30   | 341P__1262* |

M6

| Pos.            | Part no.    |
|-----------------|-------------|
| 11 ECu, M6x28   | 340P__1069* |
| CuCrZr, M6x28   | 340P__3069* |
| Alu, ECu, M6x28 | 341P__1069* |

## Tip holders

| Pos.                                      | Part no.   |
|---|------------|
| ▶ 20 for contact tip M8                   | 342P008033 |
| for contact tip M8,<br>4mm longer version | 342P008133 |

| Pos.                                      | Part no.   |
|---|------------|
| 21 for contact tip M6                     | 342P006033 |
| for contact tip M6,<br>4mm longer version | 342P006133 |

▶ = Standard equipment

\* At the blank, please insert suitable information for torch length or wire diameter, e.g. 3 for 3 m or 08 for 0.8 mm.

## Ordering information for torches

Supplied equipped for steel wire Ø 1.0 mm

| TBi 411 Expert | with Euro central connector | 3 m | 133P421030 |
|----------------|-----------------------------|-----|------------|
|                |                             | 4 m | 133P421040 |
|                |                             | 5 m | 133P421050 |

| TBi 411 Expert | with Euro central connector and long trigger | 3 m | 133P4L1030 |
|----------------|--|-----|------------|
|                |  | 4 m | 133P4L1040 |
|                |  | 5 m | 133P4L1050 |

## Spare parts

| Pos. | Description                                    | Part no.   |
|------|--|------------|
| 50   | Torch neck TBi 411, 50°                        | 133P001001 |
| 51   | Insulating washer                              | 130P002004 |
| 60   | Handle Expert cpl., water cooled               | 380P230003 |
| 61   | Handle Expert cpl., water cooled, long trigger | 380P230004 |
| 62   | Screw for Expert handle                        | 100P541101 |
| 63   | Trigger, red, 2 poles                          | 385P021016 |
| 64   | Trigger long, red, 2 poles                     | 385P021018 |

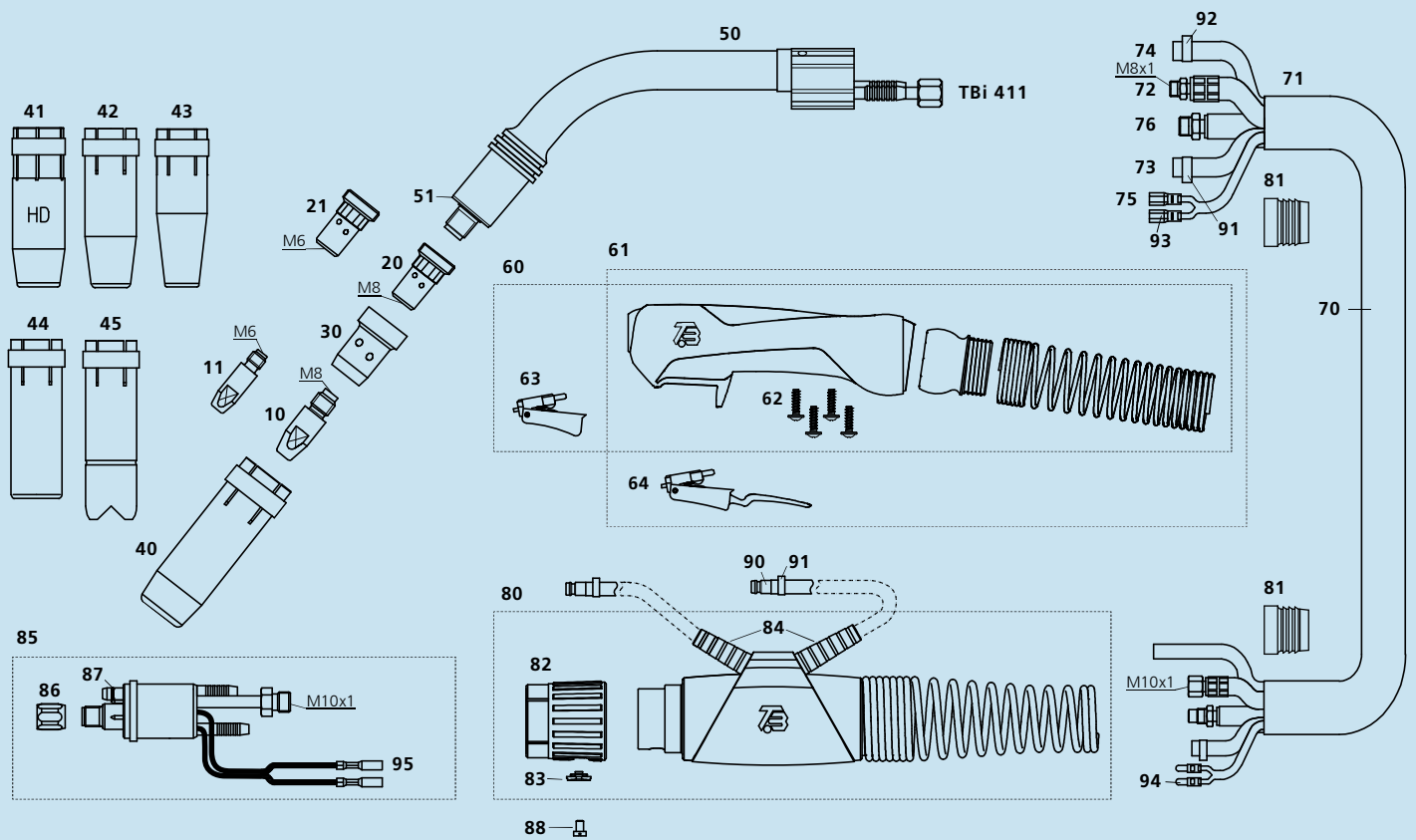

### Gas diffuser



| Pos. | Description                              | Part no.   |
|------|--|------------|
| 30   | thermoset, black, very robust            | 130P002026 |
|      | ceramic, white, extremely heat resistant | 130P002019 |

### Gas nozzle

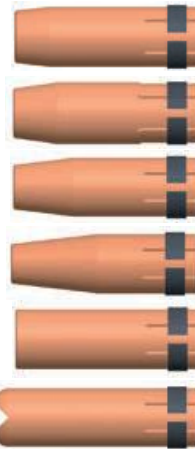

| Pos. | Description                                    | Part no.   |
|------|--|------------|
| 40   | conical, NW 16 mm<br>L= 75.5 mm                | 345P012030 |
| 41   | conical, NW 16 mm<br>Heavy Duty<br>L= 75.5 mm  | 345P012032 |
| 42   | conical, NW 14 mm<br>L= 75.5 mm                | 345P013030 |
| 43   | conical, NW 12 mm<br>only for M6<br>L= 75.5 mm | 345P016030 |
| 44   | cylindrical, NW 20 mm<br>L= 75.5 mm            | 345P011030 |
| 45   | spot welding nozzle<br>NW 20 mm<br>L= 85 mm    | 345P015030 |

| Pos. | Description                                     | Part no.    |
|------|---|-------------|
| 70   | Cable assembly Expert ,Classic', 2-C            | 123P4040_0* |
| 71   | Fabric outer cover 25x1.5 mm, for Expert        | 307P2528_E* |
| 72   | Water-power cable ,Classic', blue, 2-C          | 316P1621_0* |
| 72   | Water-power cable ,Classic', black, HD (option) | 314P1621_0* |
| 73   | PVC hose, braided, black, 5x1.5 mm              | 302P020000  |
| 74   | PVC-Gas hose, black, 4.5x1.5 mm                 | 302P010000  |
| 75   | Control cable x.30 m cpl.                       | 301P2304_0* |
| 76   | Wire conduit ,Classic', yellow                  | 356P0401_0* |
| 80   | Cable support Expert cpl., water cooled         | 700P001066  |
| 81   | Clamping ring for outer cover                   | 600P102201  |
| 82   | Adaptor nut Expert                              | 700P001010  |
| 83   | Cap for adaptor nut Expert                      | 700P002059  |
| 84   | Grommet for Expert                              | 700P002058  |

| Pos. | Description                                      | Part no.   |
|------|--|------------|
| 85   | Central adaptor ESW cpl., 2 poles, moveable pins | 701P001049 |
| 86   | Sleeve nut M10x1                                 | 701P002005 |
| 87   | O-Ring 4.0x1.0 mm (gas nipple)                   | 365P100040 |
| 88   | Screw M4x6                                       | 100P008401 |
| 90   | Quick connector                                  | 701P002064 |
| 91   | Hose clamp Ø 9.5 with ring                       | 373P100095 |
| 92   | Hose clamp Ø 8.7                                 | 371P000087 |
| 93   | Cable lug, flat                                  | 375P000023 |
| 94   | Insulated connector, male, round                 | 375P000004 |
| 95   | Insulated connector, female, round               | 375P000003 |

Ready for Tomorrow.

© 2013 Tbi Industries GmbH. All rights reserved. Subject to change without notice. Excerpts and reprints not permitted. Nr. DOKP110012, 06/2013.

Tbi Industries GmbH  
Ruhberg 14  
D-35463 Fernwald-Steinbach  
P.O. Box 67  
D-35461 Fernwald-Steinbach

Tel. + 49 6404 9171-0  
Fax. + 49 6404 9171-40  
Internet: [www.tbi-industries.com](http://www.tbi-industries.com)  
E-mail: [info@tbi-industries.com](mailto:info@tbi-industries.com)